

EP75.000
N770.000

EP76.000
N770.000

EP75.000
N768.000

EP76.000
N768.000

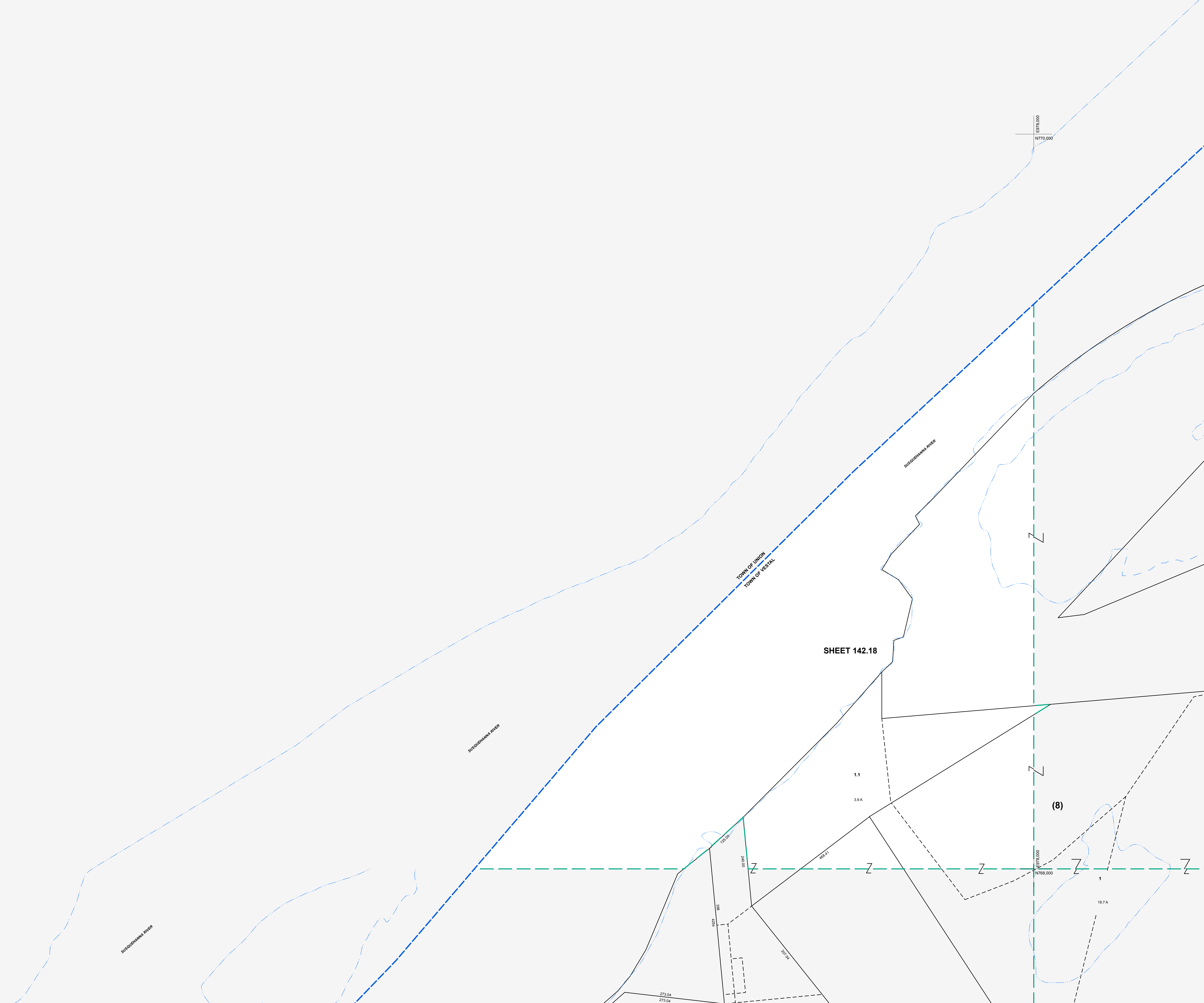

MAP REVISIONS		
DATE	MADE BY	REVISIONS
2/18/1999	TR	COMB. A PORTION OF 142.18-1.1 & A
2/18/1999	TR	PORTION OF 158.06 TO MAKE 158.06-1-6.2
6/11/1997	DC	142.04-1-8.1 CHANGED TO 142.18-1.1

SCHOOL DISTRICT AND SPECIAL DISTRICTS	
FIRE: VESTAL FIRE DISTRICT	SCHOOL: VESTAL SCHOOL DISTRICT

LEGEND	
PROPERTY LINE	———
RIGHT OF WAY LINE	———
MUNICIPAL BOUNDARY	-----
SUBDIVISION LIMIT	-----
COUNTY LINE	-----
ORIGINAL LOT LINE	-----
RAILROAD	———
STREAM	~~~~~
BLOCK LIMIT	-----
SCHOOL DISTRICT LINE	———
FIRE DISTRICT LINE	———
DENOTES COMMON OWNER	①
PARCEL NUMBER	10
ORIGINAL SUBLOT NUMBER	10
TAX MAP BLOCK NUMBER	①
TAX MAP PARCEL NUMBER	08.00-1-10
CALCULATED ACREAGE	20.5 A(±)
DEED ACREAGE	20.5 A
SCALED DIMENSION (FEET)	150 (±)
DEED DIMENSION (FEET)	150
COORDINATE LOCATOR	*

1983 North American Datum
New York State Plane, Central Zone

THIS MAP WAS PRODUCED FOR TAX PURPOSES ONLY AND IS NOT TO BE REPRODUCED OR USED FOR SURVEYING OR CONVEYANCING

TOWN	OF	UNION
		142.04
UNION	158.06	158.07

TAX MAP
TOWN OF VESTAL
BROOME COUNTY, NEW YORK

MAP DATE: 7/31/1995

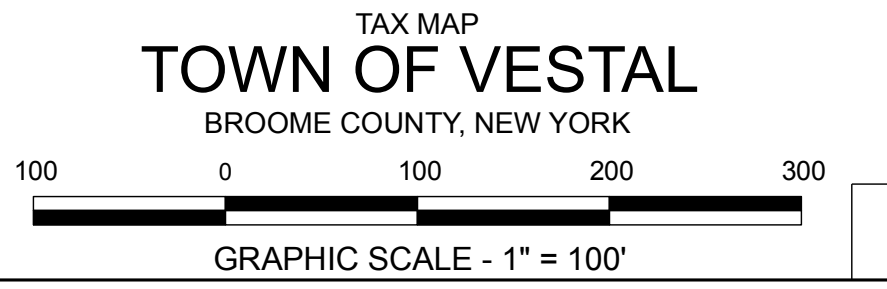

142.18