

E17605.000  
N776.000

E17605.000  
N775.000

E17605.000  
N775.000

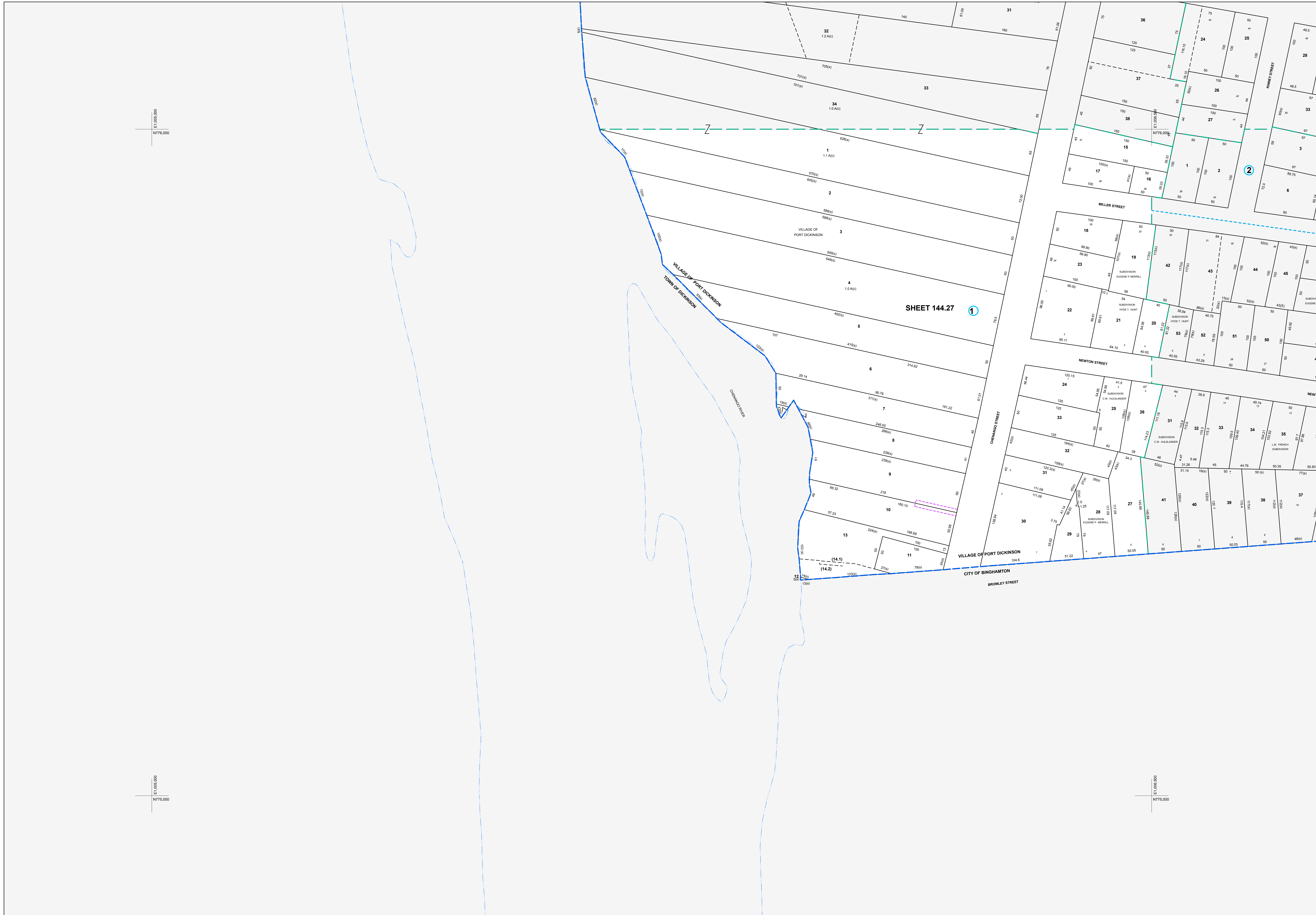

SHEET 144.27 1

2



MAP REVISIONS		
DATE	MADE BY	REVISIONS
1/5/2000	LS	COMB. 144.27-1-14.1 & 144.27-1-14.2
1/5/2000	LS	INTD 144.27-1-13
4/30/1998	TR	144.27-1-14.2 OUT OF 144.27-1-14
4/19/1998	TR	PROCESSED 10/20/97

SCHOOL DISTRICT AND SPECIAL DISTRICTS	
FIRE: PORT DICKINSON FIRE DISTRICT	SCHOOL: CHENANGO VALLEY SCHOOL DISTRICT

LEGEND	
PROPERTY LINE	———
RIGHT OF WAY LINE	———
MUNICIPAL BOUNDARY	———
SUBDIVISION LIMIT	———
COUNTY LINE	———
ORIGINAL LOT LINE	———
RAILROAD	———
STREAM	———
BLOCK LIMIT	———
SCHOOL DISTRICT LINE	———
FIRE DISTRICT LINE	———
DENOTES COMMON OWNER	①
PARCEL NUMBER	10
ORIGINAL SUBD LOT NUMBER	10
TAX MAP BLOCK NUMBER	①
TAX MAP PARCEL NUMBER	08.00-1-10
CALCULATED ACREAGE	20.5 A(c)
DEED ACREAGE	20.5 A
SCALED DIMENSION (FEET)	150
DEED DIMENSION (FEET)	150
COORDINATE LOCATOR	*

1983 North American Datum  
New York State Plane, Central Zone

THIS MAP WAS PRODUCED FOR TAX PURPOSES ONLY AND IS NOT TO BE REPRODUCED OR USED FOR SURVEYING OR CONVEYANCING

TOWN	128.83	128.84
OF		144.28
DICKINSON	CITY OF	BINGHAMTON

TOWN	128.83	128.84
OF		144.28
DICKINSON	CITY OF	BINGHAMTON

TAX MAP  
**VILLAGE OF PORT DICKINSON**  
BROOME COUNTY, NEW YORK

MAP DATE 10/19/1994

GRAPHIC SCALE - 1" = 50'

144.27