

E 012,500
N 782,000

E 012,500
N 782,000

E 012,500
N 781,000

E 012,500
N 781,000

TOWN OF FENTON
VILLAGE OF PORT DICKINSON

SHEET 129.39

PILGRIM HOLINESS CHURCH INC.

PILGRIMAGE AND HUTTON PARK ROAD
VILLAGE OF PORT DICKINSON
TOWN OF DICKINSON

Z



MAP REVISIONS		
DATE	MADE BY	REVISIONS

SCHOOL DISTRICT AND SPECIAL DISTRICTS	
FIRE: PORT DICKINSON FIRE DISTRICT	SCHOOL: CHENANGO VALLEY SCHOOL DISTRICT

LEGEND	
PROPERTY LINE	———
RIGHT OF WAY LINE	———
MUNICIPAL BOUNDARY	-----
SUBDIVISION LIMIT	-----
COUNTY LINE	-----
ORIGINAL LOT LINE	-----
RAILROAD	——+——
STREAM	~~~~~
BLOCK LIMIT	———
SCHOOL DISTRICT LINE	—SCH—
FIRE DISTRICT LINE	—F—
DENOTES COMMON OWNER	Z
PARCEL NUMBER	10
ORIGINAL SUBD LOT NUMBER	10
TAX MAP BLOCK NUMBER	①
TAX MAP PARCEL NUMBER	08.00-1-10
CALCULATED ACREAGE	20.5 A(c)
DEED ACREAGE	20.5 A
SCALED DIMENSION (FEET)	150 (3)
DEED DIMENSION (FEET)	150
COORDINATE LOCATOR	•

1983 North American Datum
New York State Plane, Central Zone

THIS MAP WAS PRODUCED FOR TAX PURPOSES ONLY AND IS NOT TO BE REPRODUCED OR USED FOR SURVEYING OR CONVEYANCING

TOWN	OF	FENTON
129.09		TOWN
OF	DICKINSON	DICKINSON

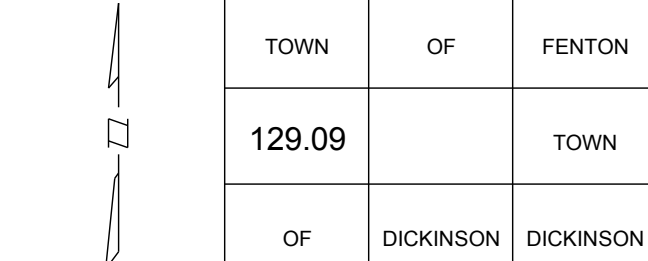

TAX MAP
VILLAGE OF PORT DICKINSON
BROOME COUNTY, NEW YORK

50 0 50 100 150
GRAPHIC SCALE - 1" = 50'

MAP DATE 10/19/1994

129.39