

E 983.000
 299,619 M
 E 984.500
 300,076 M
 E 986.000
 300,532 M
 E 987.500
 300,991 M
 E 990.000
 301,753 M
 E 991.500
 302,210 M
 E 993.000
 302,667 M
 E 994.500
 303,124 M
 E 996.000
 303,581 M
 E 997.500
 304,039 M
 E 999.000
 304,496 M
 E 1,000.500
 304,953 M
 E 1,002.000
 305,410 M
 E 1,003.500
 305,867 M
 E 1,005.000
 306,325 M
 E 1,006.500
 306,782 M
 E 1,008.000
 307,239 M
 E 1,009.500
 307,696 M
 E 1,011.000
 308,153 M
 E 1,012.500
 308,611 M
 E 1,014.000
 309,068 M
 E 1,015.500
 309,525 M
 E 1,017.000
 309,982 M
 E 1,018.500
 310,439 M

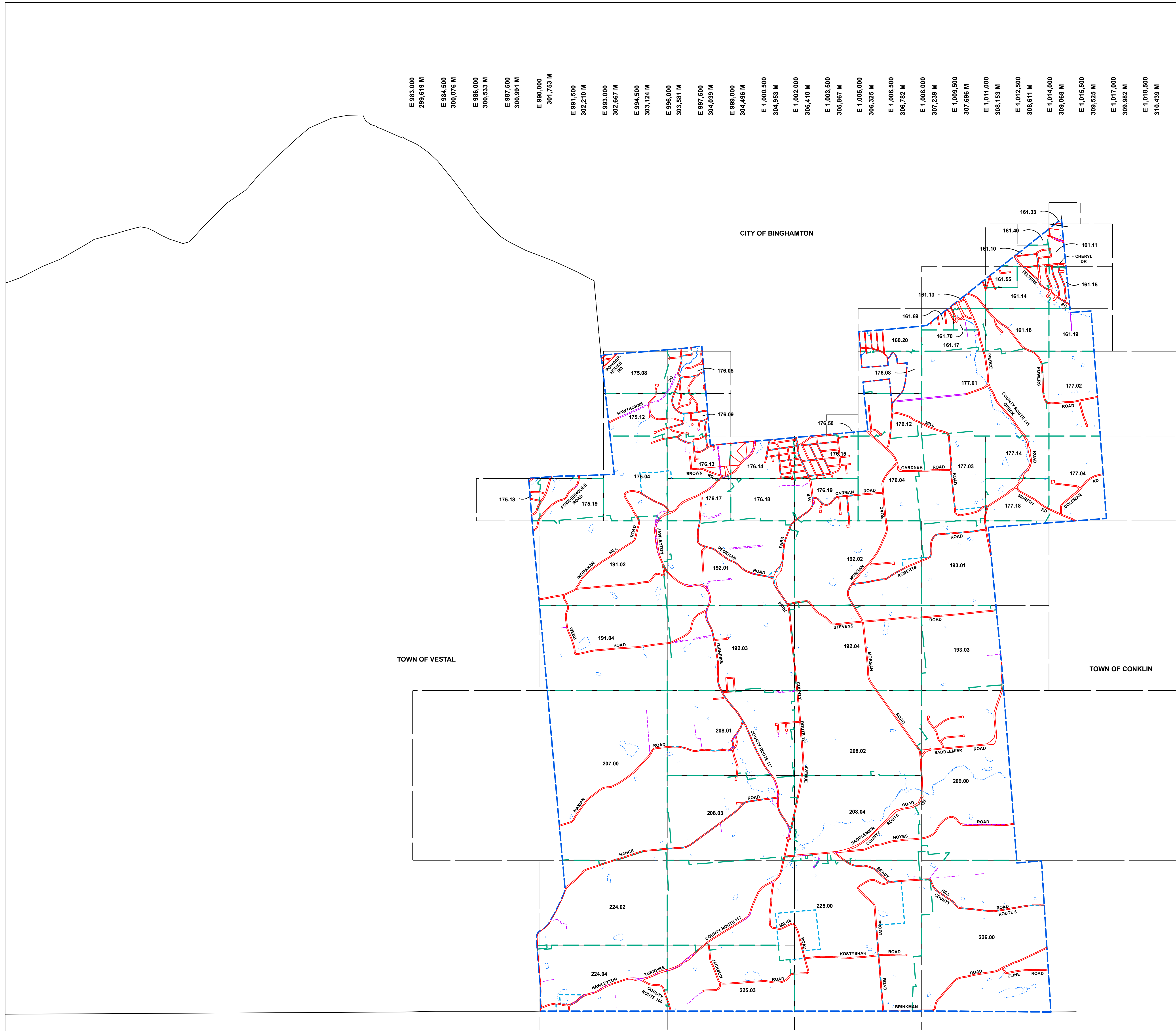

N 770,000
 234,696 M
 N 768,000
 234,087 M
 N 766,000
 233,477 M
 N 764,000
 232,868 M
 N 762,000
 232,258 M
 N 760,000
 231,648 M
 N 758,000
 231,039 M
 N 756,000
 230,429 M
 N 754,000
 229,820 M
 N 752,000
 229,210 M
 N 750,000
 228,600 M
 N 748,000
 227,991 M
 N 746,000
 227,381 M
 N 744,000
 226,772 M
 N 742,000
 226,162 M
 N 740,000
 225,552 M
 N 738,000
 224,943 M
 N 736,000
 224,333 M
 N 734,000
 223,724 M
 N 732,000
 223,114 M
 N 730,000
 222,504 M
 N 728,000
 221,895 M

COMMONWEALTH OF PENNSYLVANIA



MAP REVISIONS		
DATE	MADE BY	REVISIONS

SCHOOL DISTRICT AND SPECIAL DISTRICTS	
FIRE:	SCHOOL:

LEGEND	
PROPERTY LINE	RAILROAD
RIGHT OF WAY LINE	STREAM
MUNICIPAL BOUNDARY	BLOCK LIMIT
SUBDIVISION LIMIT	SCHOOL DISTRICT LINE
COUNTY LINE	FIRE DISTRICT LINE
ORIGINAL LOT LINE	

DENOTES COMMON OWNER	10
PARCEL NUMBER	10
ORIGINAL SPLIT LOT NUMBER	10
TAX MAP BLOCK NUMBER	10

1983 North American Datum
 New York State Plane, Central Zone
 THIS MAP WAS PRODUCED FOR TAX PURPOSES ONLY AND IS NOT TO BE REPRODUCED OR USED FOR SURVEYING OR CONVEYANCING

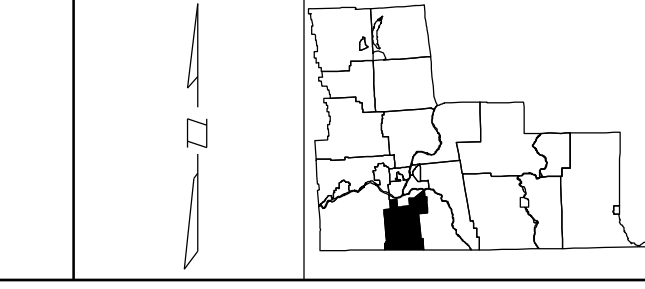

TAX MAP
TOWN OF BINGHAMTON
 BROOME COUNTY, NEW YORK

2000 0 2000 4000 6000

GRAPHIC SCALE - 1" = 2000'

INDEX

MAP DATE 06/04/95